

# RIOCAN YONGE EGLINTON CENTRE

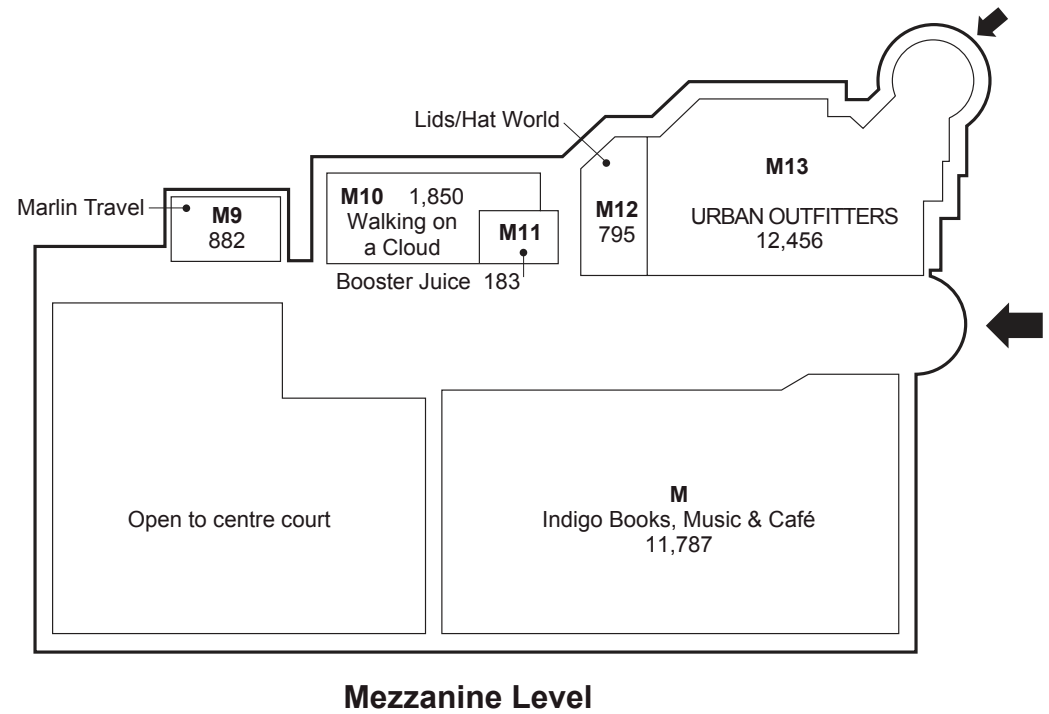

existing property

**ADDRESS** 2300 Yonge Street, Toronto, Ontario **INTERSECTION** Yonge Street and Eglinton Avenue West **TOTAL COMPLEX** 1,014,517 sq ft

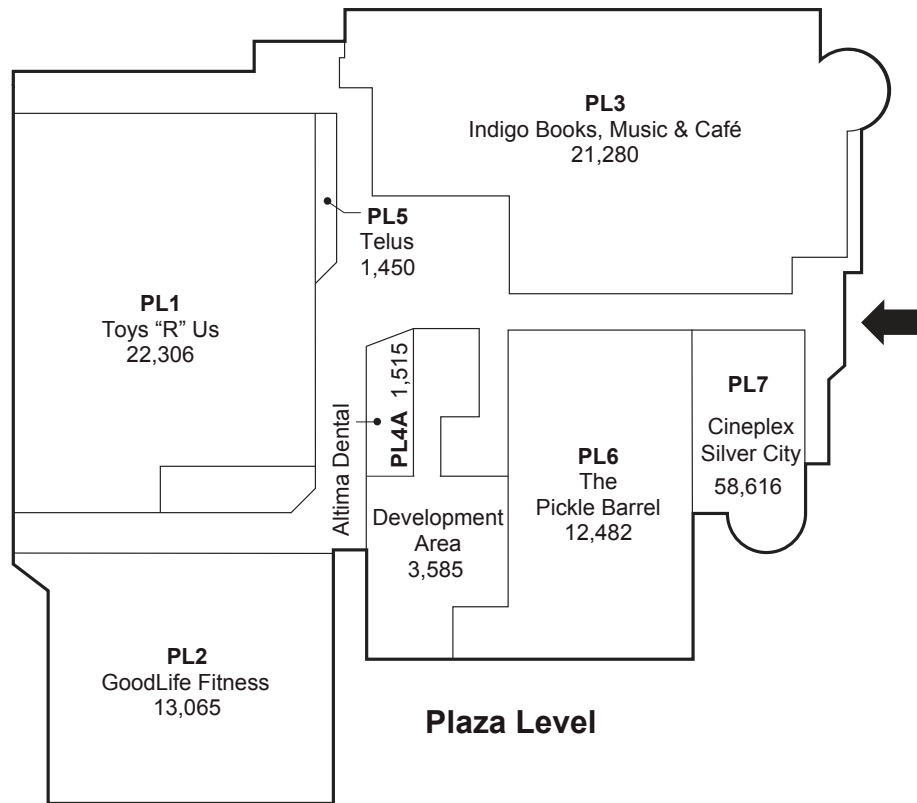
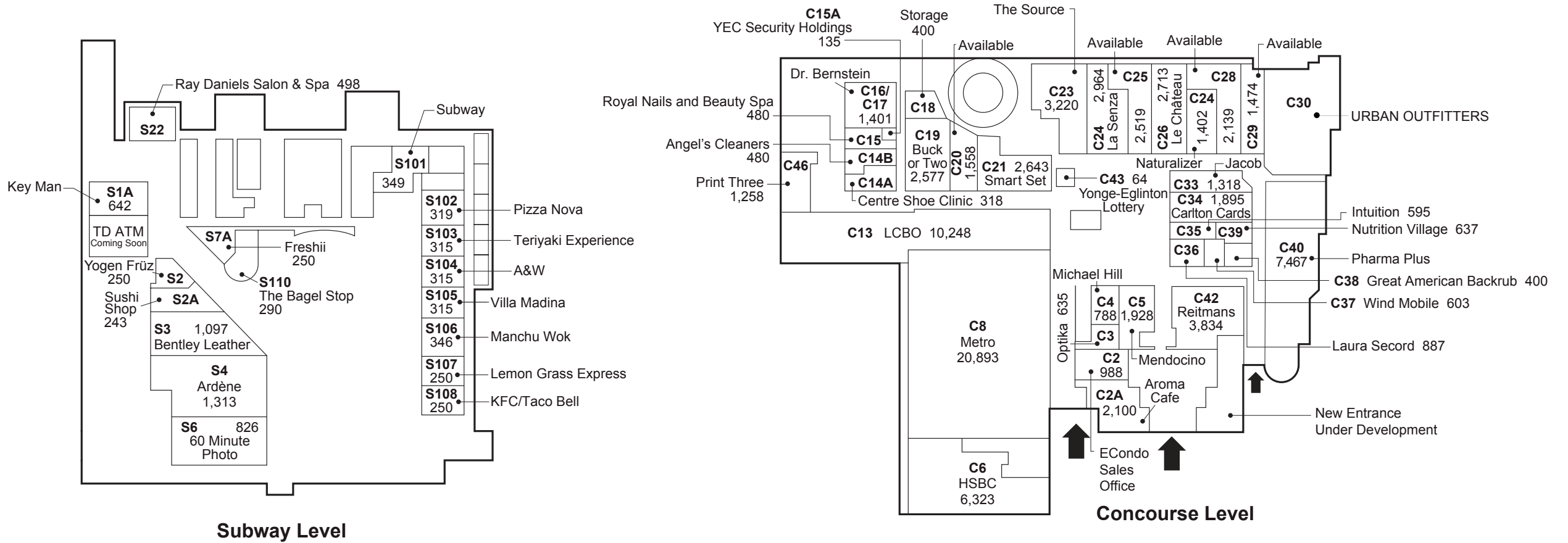

existing property

# RIOCAN YONGE EGLINTON CENTRE



**ADDRESS** 2300 Yonge Street, Toronto, Ontario **INTERSECTION** Yonge Street and Eglinton Avenue West **TOTAL COMPLEX** 1,014,517 sq ft



The purpose of this plan is to identify the approximate location, size and dimension of the Leased Premises in the Shopping Center. The Landlord reserves the right at any time to relocate, rearrange, alter or expand the building and structures, other premises, the Common Areas, and any part of the Leased Premises from that shown on this plan. All information, dimensions, sizes and areas are approximate only and are to be verified on site. Any references on this plan to specific tenants are subject to change from time to time and shall not be deemed to be any representation as to the tenants that are within the Shopping Center. 04/14

# RIOCAN YONGE EGLINTON CENTRE

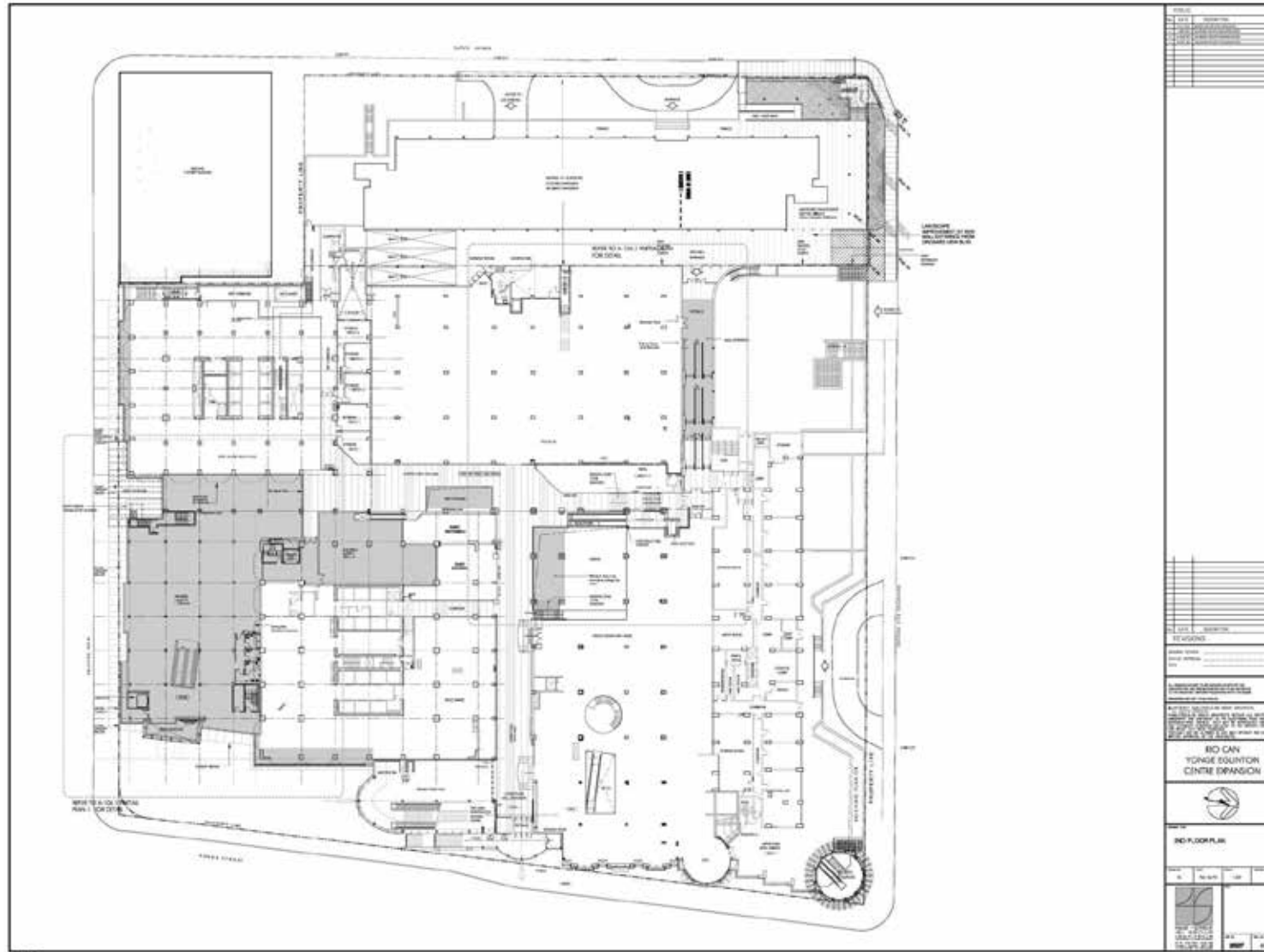





# RIOCAN YONGE EGLINTON CENTRE

